



**HUAWEI**

**HUAWEI HG630a**

**Router Mode**

**Setup Guide v1.0**

# HUAWEI HG630a Router Mode Setup Guide

## 1. Router & Internet Connection

### 1.1 Option 1: Terminal Device

Please try to connect the router to the ONT (Optical Network Terminal device)

1. Connect power adapter and press the **“On/Off”** button of the router. Wait for 30s.
2. Normally, you can **find your ONT** (as shown in the following figure) in your garage or cabinet. ONT is not a Router and please ensure ONT is on. For some modes of ONT, you may need take off the lid to find ports.

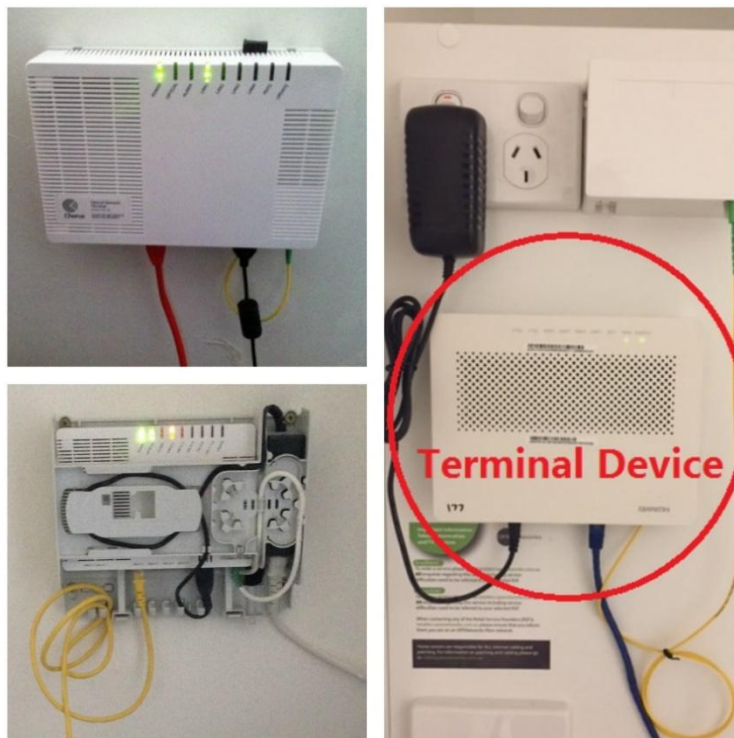

3. Connect the **blue** “WAN” port of router to “ONT port 1” below with Internet Cable.

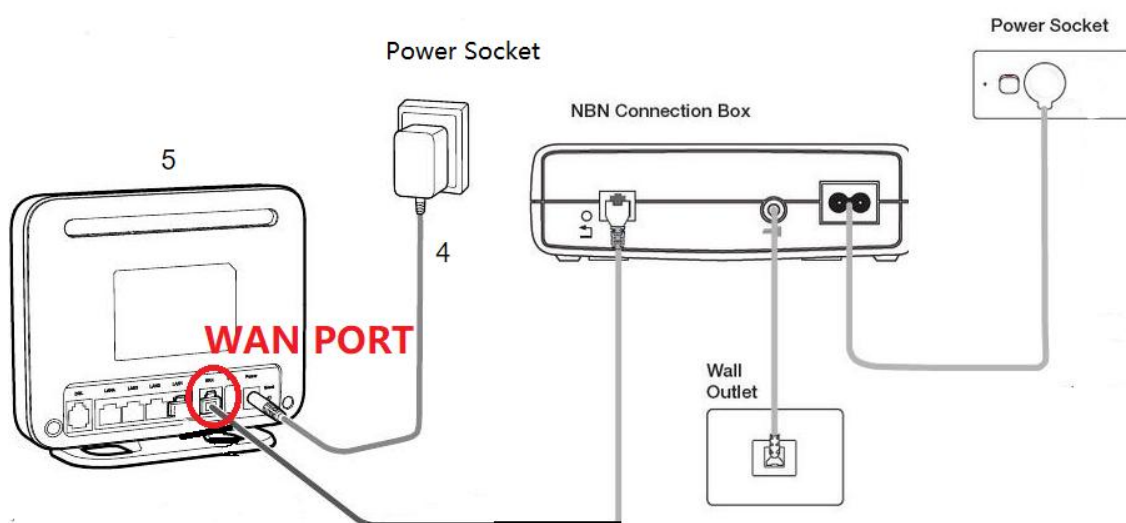
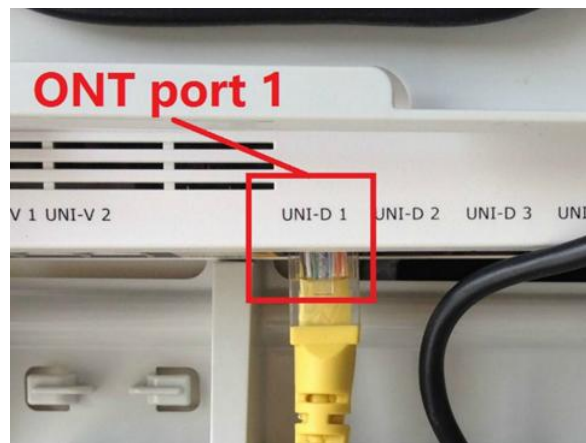

## 1.1 Option 2: Sockets on the wall

Sometimes, you **cannot find the terminal device**, please try the **Internet sockets** on the wall in your living room.

1. Connect power adapter and plug the cable from socket on the wall into the WAN port of router.

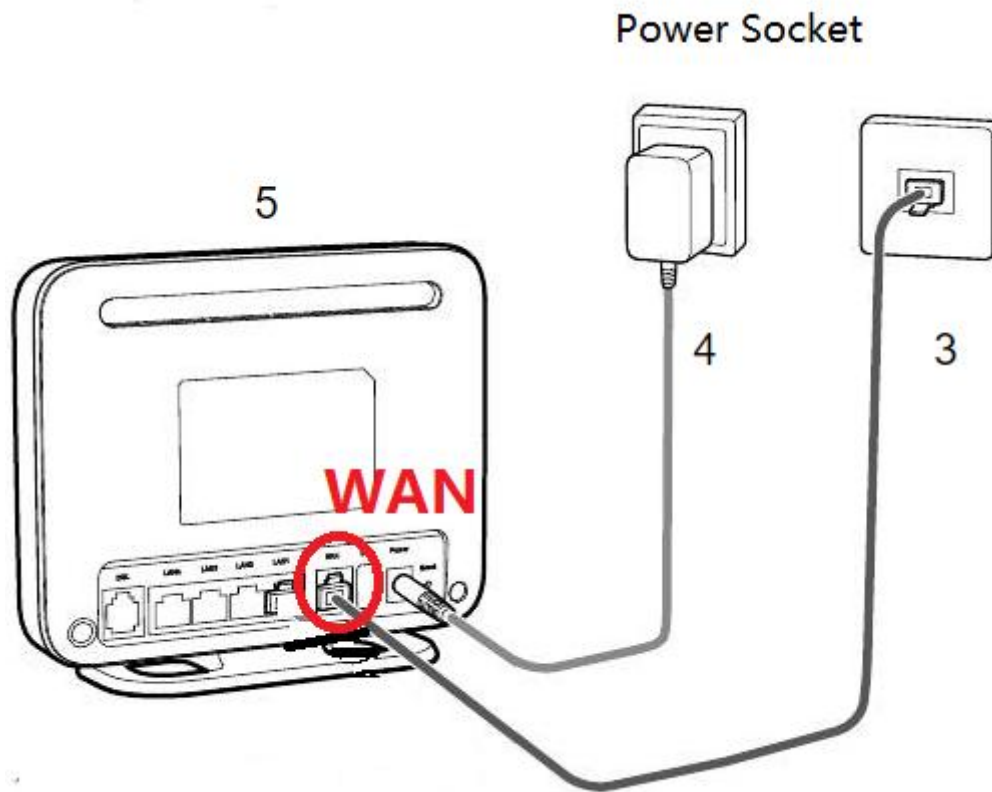

2. Press "On/Off" button to power on router and wait for 30 seconds.

## 1.2 LED

- (1) After step 1.1, please make sure WAN indicator on the router is on. Please **contact us** if the light is still off.
- (2) Please follow the steps to configure the router.



## 2. Setup Connection

### 2.1 Connect laptop to the router

#### Option 1: Wi-Fi Connection

- (1) Click Internet icon
- (2) Select your router in networks list and click “connect”
- (3) Type in password to get connected (Wi-Fi password can be found on the back of the router)

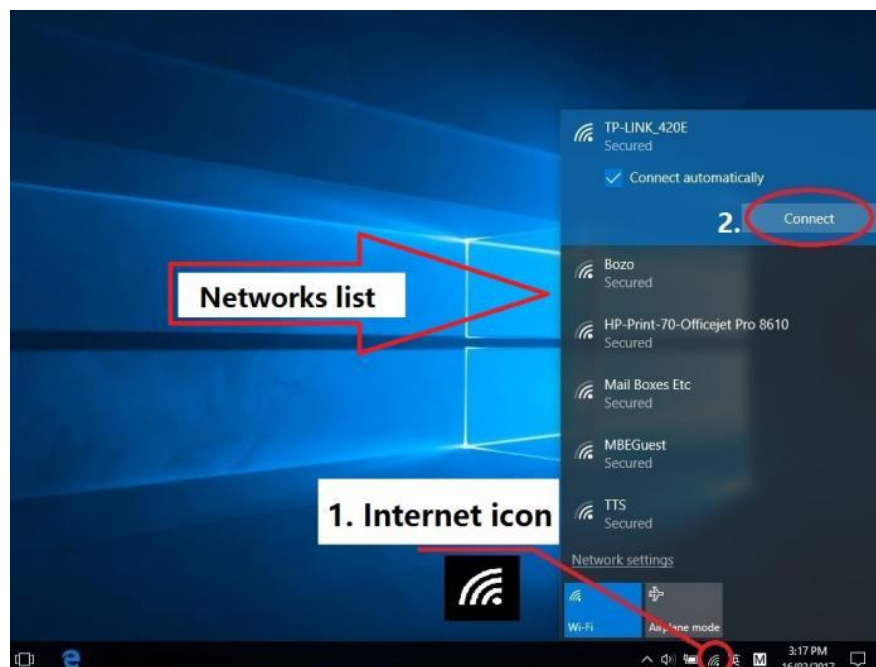

#### Option 2: Cable Connection (If you don't need the Wi-Fi)

- (1) Connect PC to any of LAN ports (1 –4 of router) via Internet cable.
- (2) Choose Connection in Networks list.

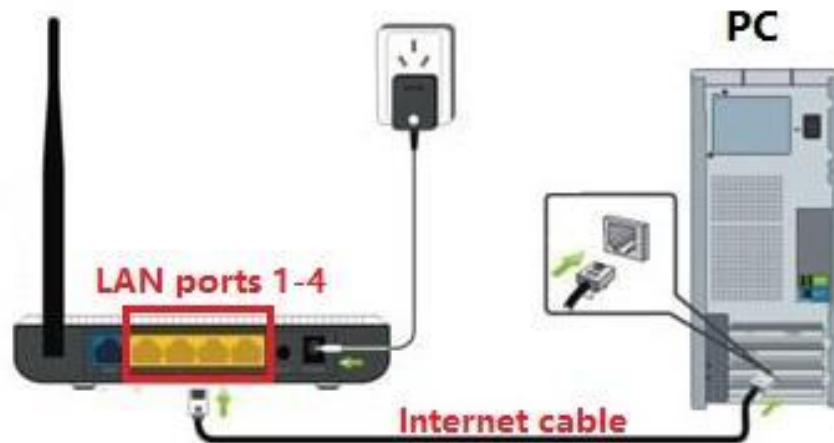

### 3. Login WIFI configuration page

3.1. Open Internet browser and input **http://192.168.1.1** on address bar to the router configuration page.

3.2. Input “admin” as Username and “admin” as Password, then click “log in”.

The screenshot shows the login interface of the Huawei Home Gateway. The page title is "HUAWEI Home Gateway". The login form contains the following elements:

- Username field: admin
- Password field: admin
- Message: Please enter your username and password.
- Login button
- Cancel button

A red oval highlights the text "Username: admin" and "Password: admin". A red box highlights the Login button.

## 4. WAN Configuration

4.1 Click “Basic” on the left.

4.2 Then select “Link Interface” in the Basic.

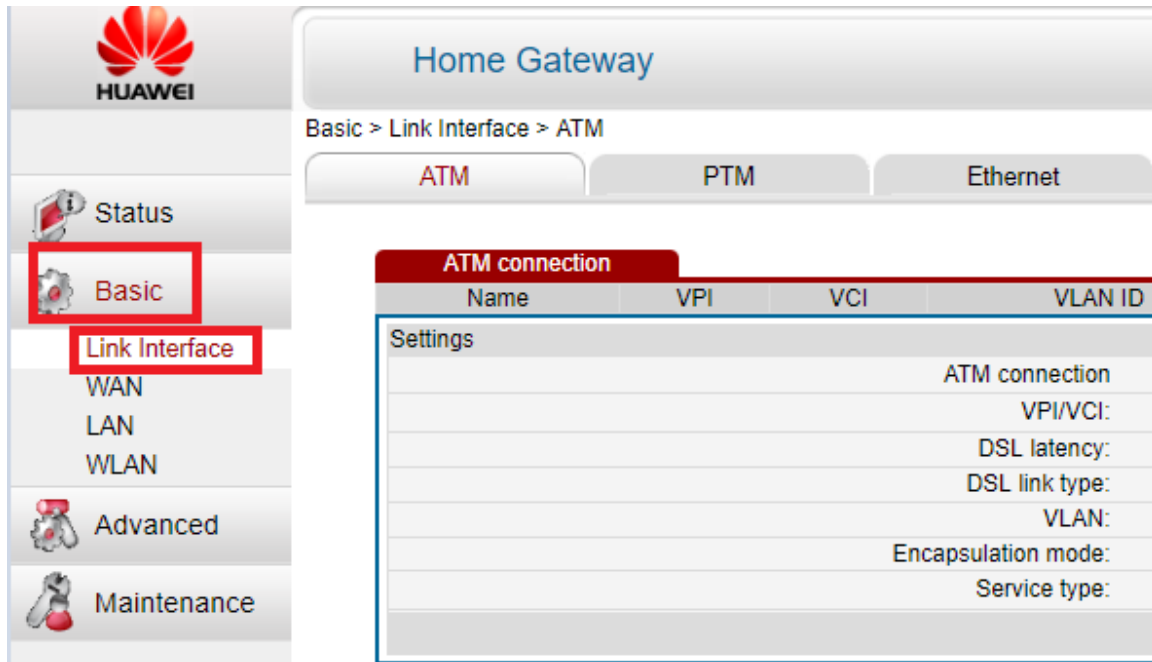

4.3. In “Link Interface”, 1. select “ATM” on the top left, 2. tick remove box on the right, 3. Click “Remove” on the top right.

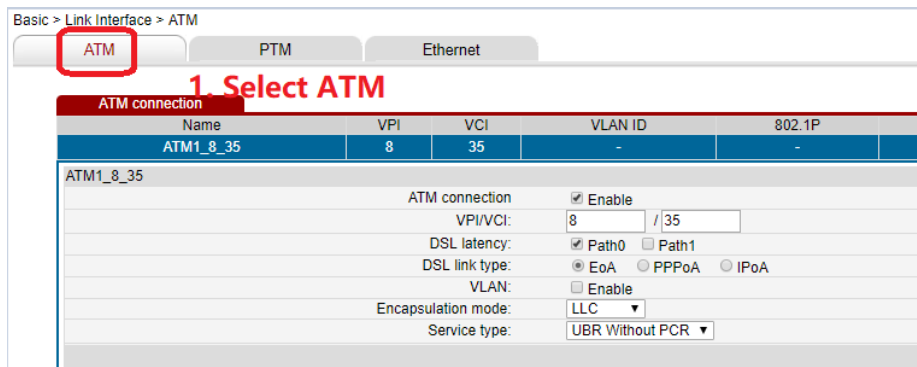

### 3. Click Remove

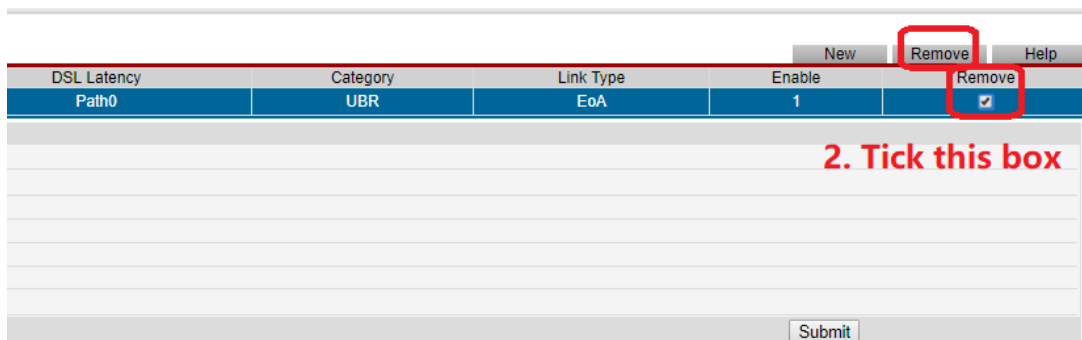

4.4 In “Link Interface”, 1. select “PTM” on the top left, 2. tick remove box on the right, 3. Click “Remove” on the top right.

Basic > Link Interface > PTM

ATM **PTM** Ethernet

**1. Select PTM**

PTM Connection

Name	DSL Latency	PTM
PTM2_VID_2	Path0	Normal

PTM2\_VID\_2

DSL latency: ☒ Path0 ☐ Path1

PTM priority: ☒ Normal Priority: ☐ High Priority:

VLAN: ☒ Enable

VLAN ID: 2 [1-4094]

802.1P: 0 [0-7]

**3. Click remove**

New Remove Help

PTM Priority	VLAN ID	802.1P	Remove
Normal	2	0	<input checked="" type="checkbox"/>

**2. Tick this box**

Submit

4.5 In “Link Interface”, 1. select “Ethernet” on the top left, 2. tick remove box on the right, 3. Click “Remove” on the top right.

Basic > Link Interface > Ethernet

ATM PTM **Ethernet**

**1. Select Ethernet**

VLAN Configuration

Name	VLAN ID	802.1P
ETH1	-	-

ETH1

VLAN ID: -1 [1-4094, -1 means No VLAN]

802.1P: -1 [0-7, -1 when VLAN ID is -1]

**3. Click Remove**

New Remove Help

802.1P	Status	Remove
-	Down	<input checked="" type="checkbox"/>

**2. Tick this box**

Submit



4.6 In “Link Interface”, 1. select “Ethernet” on the top left, 2. Click “New” on the top right, 3. Click “Submit”

Basic > Link Interface > Ethernet

ATM PTM **Ethernet**

**1. Select Ethernet**

VLAN Configuration

Name	VLAN ID	802.1P
Settings		
VLAN ID: -1	[1-4094,-1 means No VLAN]	
802.1P: -1	[0-7,-1 when VLAN ID is -1]	

**2. Click New**

New Remove Help

2.1P Status Remove

**3. Click Submit**

Submit

4.7 Select “WAN” under Basic on the left.

HUAWEI

Home Gateway

Basic > WAN

WAN

WAN Connection

Name

Settings

Status

**Basic**

Link Interface

**WAN**

LAN

WLAN

Advanced

Maintenance

4.8 In the WAN Connection Setting, Make sure Connection device is “ETH1”.

4.9 Tick “LAN 1, LAN 2, LAN 3, LAN4, SSID 1” in the Bind list.

4.10 Select “IPv4” for IP type.

4.11 Input the PPPoE username and password provided by us (you can find the PPPoE username and password in the activation email) as User name and Password.

Connection Type	Connection Status	IP Type	Enable
Connection device: <b>ETH1</b>			
WAN connection: <input checked="" type="checkbox"/> Enable			
Service list: <input checked="" type="checkbox"/> INTERNET <input type="checkbox"/> TR069			
Bind list: <input checked="" type="checkbox"/> LAN1 <input checked="" type="checkbox"/> LAN2 <input checked="" type="checkbox"/> LAN3 <input checked="" type="checkbox"/> LAN4	<input type="checkbox"/> SSID1 <input type="checkbox"/> SSID2 <input type="checkbox"/> SSID3 <input type="checkbox"/> SSID4		
Connection type: <b>PPPoE</b>			
P type: <b>IPv4</b>			
Authentication mode: Auto			
Connection trigger: AlwaysOn			
User name: <input type="text"/>			
Password: <input type="password"/>			
Tunnel type: None			
MRU: Auto Size: 1492			
MSS: Auto Size: 1452			
<b>Submit</b>			

Input the PPPoE username and password provided by us in the activation email

4.12 Click "Submit"

## 5. Optional Step: Change Wi-Fi name & password

5.1. Select "WLAN" under Basic on the left.



Home Gateway

Basic > WLAN > WLAN

WLAN

WLAN Filtering

WLAN WDS

Status

**Basic**

Link Interface

WAN

LAN

**WLAN**

Advanced

Maintenance

☒ Enable WLAN

Wireless Settings

	Region
	C
	Band
	Guard I
	Transmit
	SSID
Maximum Number of Accessing C	

5.2 In wireless settings, change your WIFI name in "SSID", and Change your password in "WPA Pre-Shared Key". Then Click "Submit" at the bottom.

Wireless Settings	
Mode:	802.11b/g/n ▼
Region Code:	AUSTRALIA ▼
Channel:	Auto ▼
Band Width:	20/40 ▼ MHz
Guard Interval:	long ▼
Transmit power:	100% ▼
SSID:	SSID ▼
SSID:	OCCOM-9EEC84 ▼
Maximum Number of Accessing Devices:	16 ▼
Enable SSID:	<input checked="" type="checkbox"/> Enable
Hide Broadcast:	<input type="checkbox"/> Enable
Enable WMM:	<input checked="" type="checkbox"/> Enable
Security Mode:	WPA-PSK/WPA2-PSK ▼
WPA Pre-Shared Key:	***** ▼
WPA Encryption:	TKIP+AES ▼
Enable WPS:	<input checked="" type="checkbox"/> Enable
WPS Mode:	PBC ▼
<div>Submit</div>	

***Congratulations. You have successfully configured your router, it's time to enjoy your network.***